



Lesite Technology

# Electric Hot Cutter

LH8100

LH8150

LH8200

LH8250

Manual

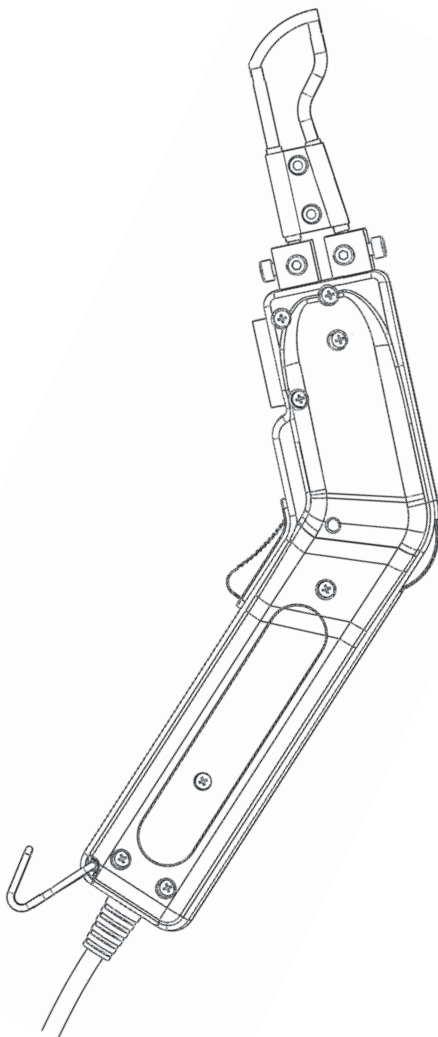



**Please read this manual carefully before using this machine, and keep it for future reference**

## Application

- (1) Sponge foam: sponge, foam, foam slotting, EPS, EVA, pearl cotton, bubble pad and so on
- (2) Rubber plastic: plastic, rubber, plastic opening, acrylic cutting, benzene board cutting, KT board, advertising cloth, carpet, PVC pipe, all kinds of plastic sheet, nylon pipe, plastic pipe, cable and so on
- (3) Cable: synthetic fabric, cable, braided belt, ton bag, PVC rope, Nylon rope, packing belt, mesh fabric, etc
- (4) Cloth leather category: cloth, non-woven cloth, curtain cloth, canvas, nylon cloth, waterproof cloth, leather, carpet and so on
- (5) Other categories: cork, dirt cleaning, aluminum film



## Precautions



Please confirm that the machine is turned off and unplugged before disassembling the welding machine, so as not to be injured by live wires or components inside the machine.



Don't burn the residue on the blade, or it would warp.  
Don't burn the blade hot while no cutting materials.



Don't touch the blade in case of electrical heating and don't keep it close to clothes or other inflammables. Deal with the blade when it cools down in order to avoid accidental injury.



The power supply voltage must match the rated voltage marked on the hot cutter and be reliably grounded.



In order to ensure the safety of the operators and the reliable operation of the equipment, the power supply at the construction site must be equipped with a regulated power supply and a leakage protector.



The hot cutter must be operated under the correct control of the operator, otherwise it may cause combustion or explosion due to high temperature.



Don't use the tool on a wet desk or ground in case of electric shock.  
Don't operate the tool with wet hands in order to avoid electric shock.

## Parameter

Model	LH8100	LH8150
Rated Voltage	230 V / 120 V	230 V / 120 V
Frequency	50 / 60 Hz	50 / 60 Hz
Rated Power	100W	150W
Temperature Regulation	Adjustable	Adjustable
Blade Temperature	50-600°C	50-600°C
Power Wire Length	3 m	3 m
Product Size	24 X 4.5 X 3.5 cm	24 X 4.5 X 3.5 cm
Package Size	28 X 23 X 8 cm	28 X 23 X 8 cm
Net Weight	395 g	395 g

Model	LH8200	LH8250
Rated Voltage	230 V / 120 V	230 V / 120 V
Frequency	50 / 60 Hz	50 / 60 Hz
Rated Power	200W	250W
Temperature Regulation	Adjustable	Adjustable
Blade Temperature	50-600°C	50-600°C
Power Wire Length	3 m	3 m
Product Size	24 X 4.5 X 3.5 cm	24 X 4.5 X 3.5 cm
Package Size	28 X 23 X 8 cm	28 X 23 X 8 cm
Net Weight	395 g	395 g

## Main Parts

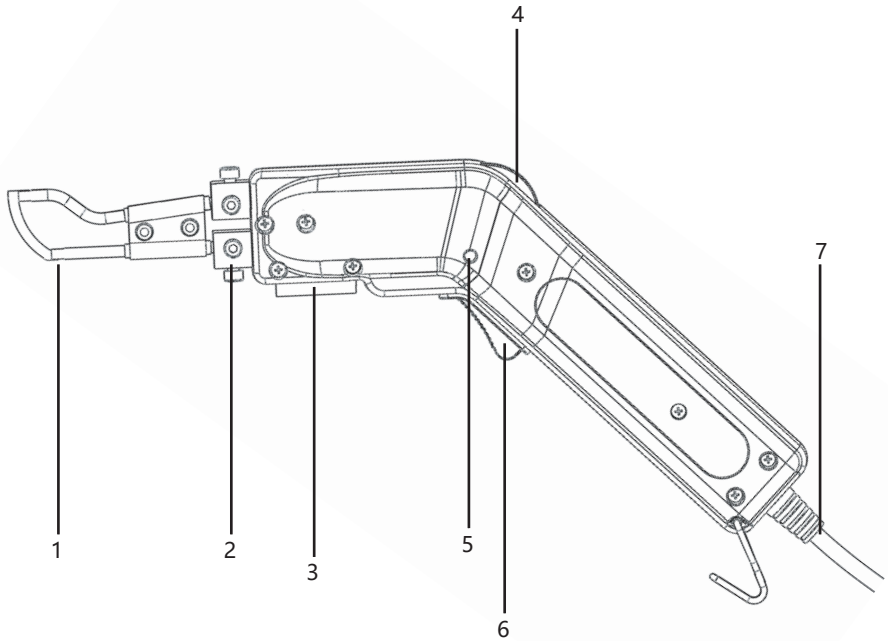

1.Blade

2.Blade Holder

3.Auxiliary Mount

4.Temperature Button

5.Indicator Light

6.Switch on/off

7.Power Wire



## Operation

1. Turn on the power.
2. Adjust the temperature button, the higher the temperature if rotated inward and the lower the temperature with outward rotation.
3. Press the temperature button and put the blade on the object. Turn it on and warm up for seconds. It recommended to test cutting waste materials before cutting.
4. In the process of use, when the blade reaches the cutting temperature, intermittent point switch to maintain the consistency of temperature and speed, improve the work efficiency, prolong the service life.
5. Attention: it is recommended to keep the temperature stable by intermittently releasing the heating switch after 10-15 minutes of continuous heating to prevent overheating and damage to the Electric Hot Cutter.

## Installation of Blade

1. When the tool is cool and not energized, unscrew the two nuts clamping the knife leg with hexagonal wrench in counter-clockwise direction.
2. Insert two legs of the blade into the holes of the two cutting heads and then tighten the two nuts to ensure knife legs and cutting heads in full contact. Improper assembling would not heat up the blade.

## Clearance of Blade

After using period of time, the material residue might be stuck on the blade, please use wire brush to clean.

## Packing list



Body



Small spanner



Wire brush



Tool kit



"R" Shape Blade (LH8100)



15cm Straight Blade (LH8150)



20cm Straight Blade (LH8200)



25cm Straight Blade (LH8250)

## Warranty

- This product guarantees a 12-month shelf life from the day it is sold to consumers. We will be responsible for failures caused by material or manufacturing defects. We will repair or replace defective parts at our sole discretion to meet the warranty requirements.
- The quality assurance does not include damage to wearing parts (blade), damage or defects caused by improper handling or maintenance, and damage caused by falling products. Irregular use and unauthorized modification should not be covered by the warranty.
- This product is not designed for continuous heating for a long time. Improper use will lead to deformation of the plastic at the front end of the Electric Hot Cutter due to overheating, which is not within the warranty scope.

## Maintenance

- It is strongly recommended to send the product to Lesite company or authorized repair center for professional inspection and repair.
- Only original Lesite spare parts are allowed.





## FUZHOU LESITE PLASTICS WELDING TECHNOLOGY CO.,LTD



Tel: +86(591)83818890



E-mail: [info@lesite.com.cn](mailto:info@lesite.com.cn)  
Web: [www.lesiteweld.com](http://www.lesiteweld.com)



Add: 5# Jingpu Road, Pushang Industry Park,  
Cangshan, Fuzhou, 350007, Fujian, China